

NOTES:

- 1. COLD HANDLE ASSY (ITEM 9) AND BLUE DYKEM LEG OF BRIDGE BODY ASSY (ITEM 2) ARE LOCATED ON THE SAME SIDE.
- 2. ASSEMBLY SHALL BE WATER TESTED AFTER ASSEMBLED.

BILL OF MATERIAL (CURRENT LEVEL)				
ITEM	PT/ASSY	DESCRIPTION	TYPE	QTY.
1	2-399	AERATOR ASM BRIDGE	ASSEMBLY	1
2	3-290	BRIDGE BODY ASSY, SIDE SPRAY	ASSEMBLY	1
3	2-472	DIVERTER ASSY, BRIDGE FAUCET	ASSEMBLY	1
4	129	HAND SPRAY	ASSEMBLY	1
5	1-117	MOUNTING HARDWARE KIT BRIDGE	ASSEMBLY	1
6	11066	RISER NUT	PART	1
7	1-152	SEAT ASSY, UPPER	ASSEMBLY	2
8	2-401	SPT ASM KITCHEN BRIDGE	ASSEMBLY	1
9	2-115	THIN BLADE X - HANDLE COLD	ASSEMBLY	1
10	2-114	THIN BLADE X - HANDLE HOT	ASSEMBLY	1

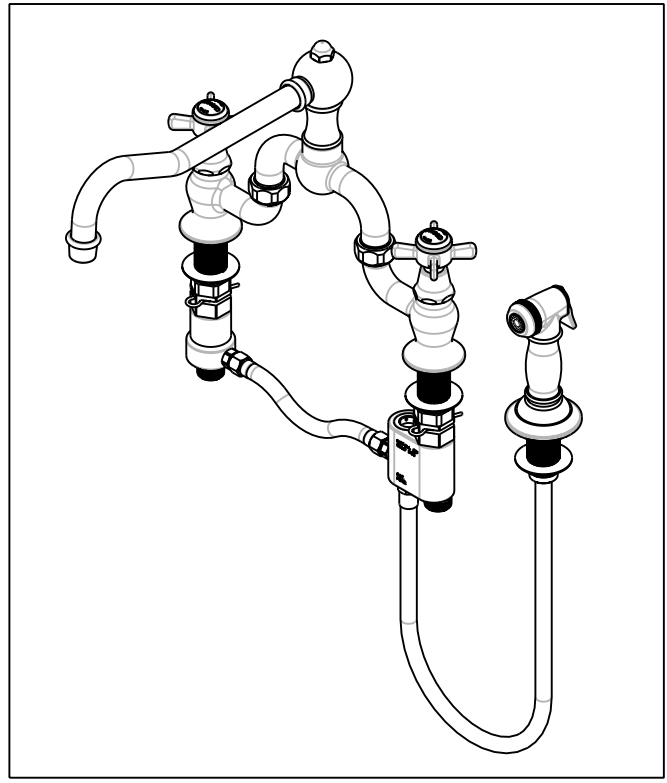
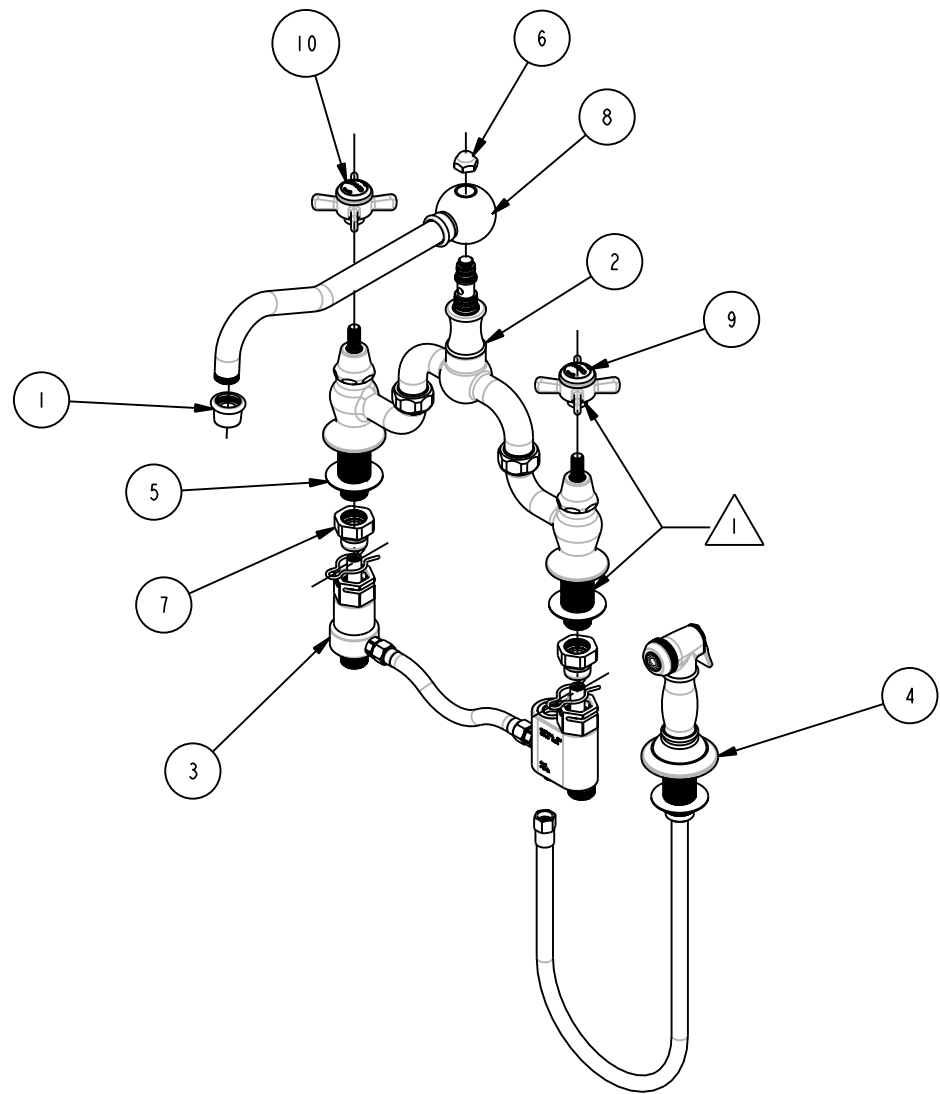

COPYRIGHT 2003 BRASSTECH, INC. THESE DRAWINGS AND THE DESIGNS DEPICTED HEREIN ARE THE PROPRIETARY PROPERTY OF BRASSTECH. ANY USE OR REPRODUCTION IS SUBJECT TO THE EXPRESS APPROVAL OF BRASSTECH. UNAUTHORIZED USE IS STRICTLY PROHIBITED. ALL RIGHTS RESERVED.

**BRASSTECH**  
INCORPORATED  
2001 E. CARNEGIE AVE.  
SANTA ANA, CA 92705  
(949) 417-5207

BRIDGE FAUCET W/ SIDE SPRAY

ASSY. NO.		9451-1		A	EO-0449	11/11/04
SCALE		REF.		SHEET 1 OF 2	REV	REV DESC
						DATE

