

**For Residential and Commercial Applications**

Job Name		Engineer / Architect	
Job Location		Wholesaler	
Submittal Date		Contractor	

## MAU1 Female Gas Adapter - 5/8" OD (15/16-16 Thread) x Female Iron Pipe

**Use:** For use with natural, manufactured, mixed, liquefied petroleum gases and LP gas-air mixtures.

**Operating Specifications:**

**Temperature:** -40° to 150° F  
**Pressure:** Up to 1/2 psi maximum

MATERIAL SPECIFICATIONS	
<b>Brass Bodies</b>	<b>C36000 brass</b>
<b>Steel Bodies</b>	<b>Blue zinc plated 12L14 or 1010 steel</b>

PART DIMENSIONS (Inches)			
Model	DIA. A	DIM. B	DIM. C
MAU1-10-12	0.50	1.78	1-1/8
MAU1-10-8	0.50	1.66	15/16

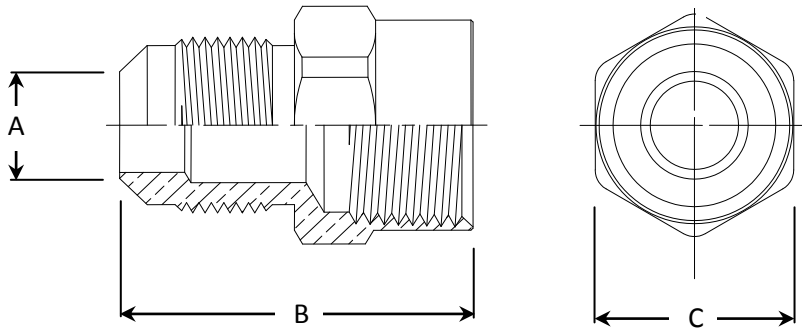

Brass Models



**Part Listing:**

- MAU1-10-12      5/8" OD Flare (15/16-16 Thread) x 3/4" F.I.P., brass
- MAU1-10-12 BT      5/8" OD Flare (15/16-16 Thread) x 3/4" F.I.P., brass, generic bag
- MAU1-10-12 K5      5/8" OD Flare (15/16-16 Thread) x 3/4" F.I.P., brass, 5 per bag
- MAU1-10-12S      5/8" OD Flare (15/16-16 Thread) x 3/4" F.I.P., steel
- MAU1-10-8      5/8" OD Flare (15/16-16 Thread) x 1/2" F.I.P., brass
- MAU1-10-8 BT      5/8" OD Flare (15/16-16 Thread) x 1/2" F.I.P., brass, generic bag
- MAU1-10-8 K5      5/8" OD Flare (15/16-16 Thread) x 1/2" F.I.P., brass, 5 per bag
- MAU1-10-8S      5/8" OD Flare (15/16-16 Thread) x 1/2" F.I.P., steel
- MAU1-10-8S B      5/8" OD Flare (15/16-16 Thread) x 1/2" F.I.P., steel, bulk

**Listings & Certifications:**

- For use with CSA listed ANSI Z21.24 / CSA 6.10 connectors
- For use with CSA listed ANSI Z21.75 / CSA 6.27 connectors

*This specification and all information contained herein is the confidential and exclusive property of BrassCraft Manufacturing, and shall not be disclosed to others without the written consent of BrassCraft. This specification must be returned to BrassCraft if requested.*

BrassCraft®